



Low Pass Filter

Features and Electrical specifications:

Model	LPF-DCG18A-S	
Frequency Range	DC-18000MHz	
Insertion Loss	≤0.6dB	
Rejection	≥25dB@21.6GHz ≥50dB@24.3-GHz	
VSWR	1.8 Max	
Rated Power	50 W	
Impedance	50 Ω	
Connector Type	SMA-F / SMA-M	
Dimension	Length: 44 mm	Diameter: 12.7 mm
Surface Finishing	Black Painting	
Operating Temperature	Ordinary Temperature	
Storage Temperature	-55 ~ +85°C	

Outline Drawing (Unit: mm):

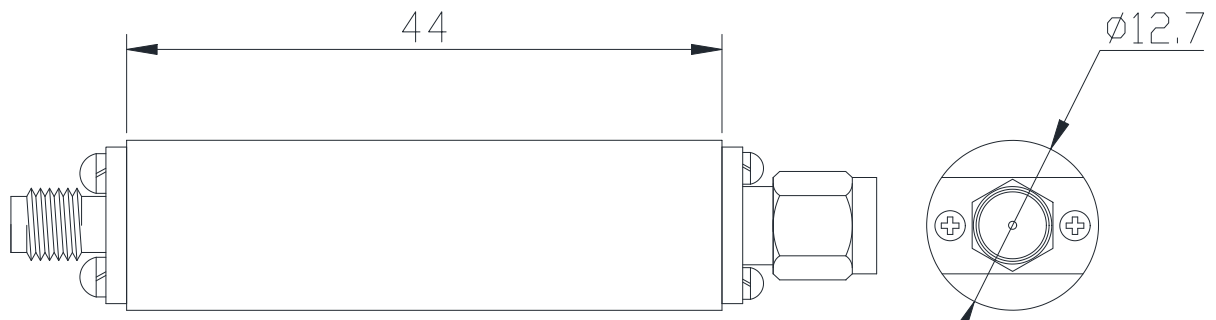
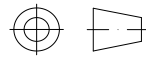

RFTYT Technology Co., LTD.

<http://www.rftyt.com>

E-mail : jackson@rftyt.com zqc7708@rftyt.com

TEL: +86-13088268828 FAX: +86-816-2846565

218# Wenwu Middle Road, Jinkai District, Mianyang, Sichuan Province China

Ready For Tackling Your Trouble