



## Low Intermodulation Termination

### Features and Electrical specifications:

Model	CT-50W-RX5015-IP65-DINK/0.35-4G
Frequency Range	0.35~4.0GHz
VSWR	1.25 Max
PIM3	≤-150dBc/-155dBc/-160dBc @2*43dBm
Power	50W
Impedance	50 Ω
Connector Type	DIN-F (K)
Waterproof Grade	IP65 or IP67
Dimension	Φ50×150mm
Operating Temperature	-35 ~ +75°C (See de Power De-rating)
Color	Black

### Outline Drawing (Unit: mm/inch):

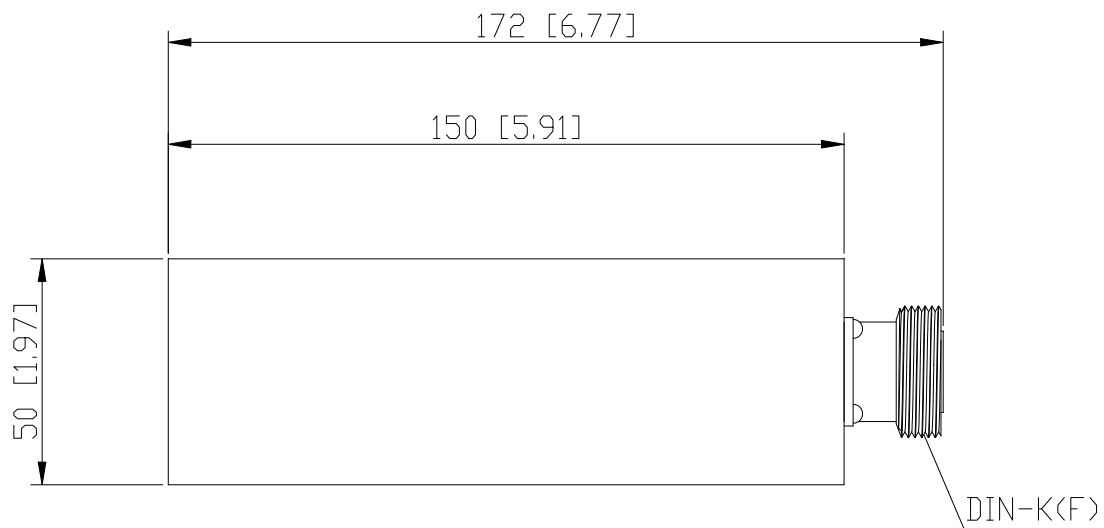
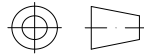



Use attention:

- 1、 Dimensions Tolerance  $\pm 5\%$ ;
- 2、 If necessary, the product shall be air-cooled for auxiliary heat dissipation;
- 3、 Custom designs available of other special Coaxial Terminations;
- 4、 Pay attention to the direction of the product during use and strictly prohibit reverse connection.

Power De-rating:

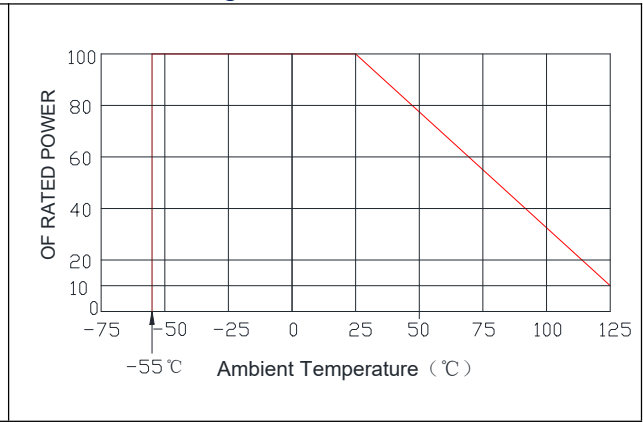

P/N Designation:

